

# Parker Series A10 Adaptor Plates for Regenerative and Hybrid Circuits Service Manual

Subplate A10-1664, mounting interface acc. DIN 24340-A10, CETOP 05 / NG10  
for A-regeneration

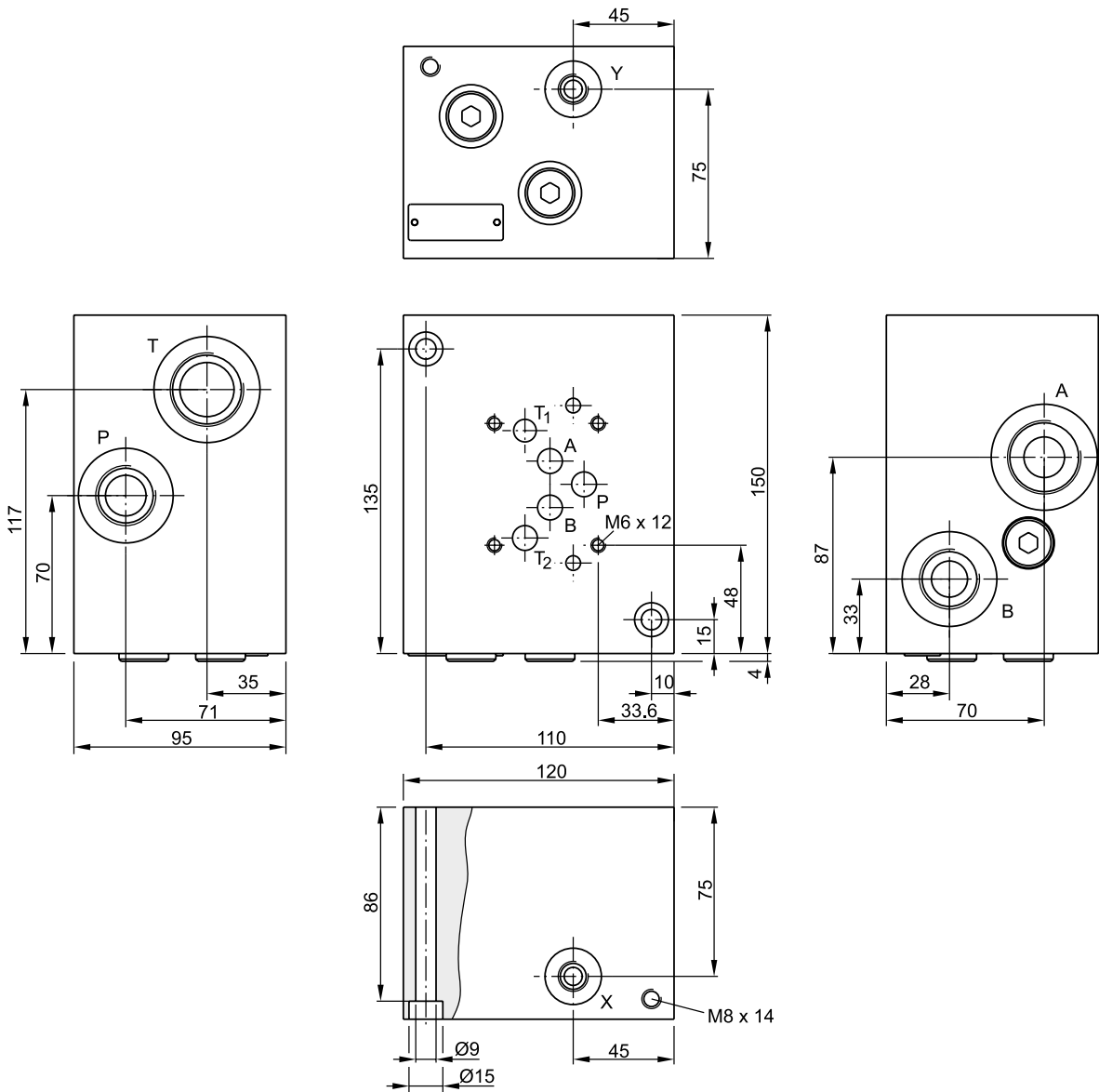

12

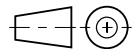

Symbol	Ordering code	Port
	<p><b>A10-1664</b> CETOP 05</p>	<p>A, T = G1 B, P = G<math>\frac{3}{4}</math> X, Y = G<math>\frac{1}{4}</math></p>

**Subplate A10-1665L, mounting interface acc. DIN 24340-A10, CETOP 05 / NG10  
 for hybrid function**

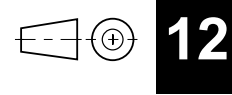
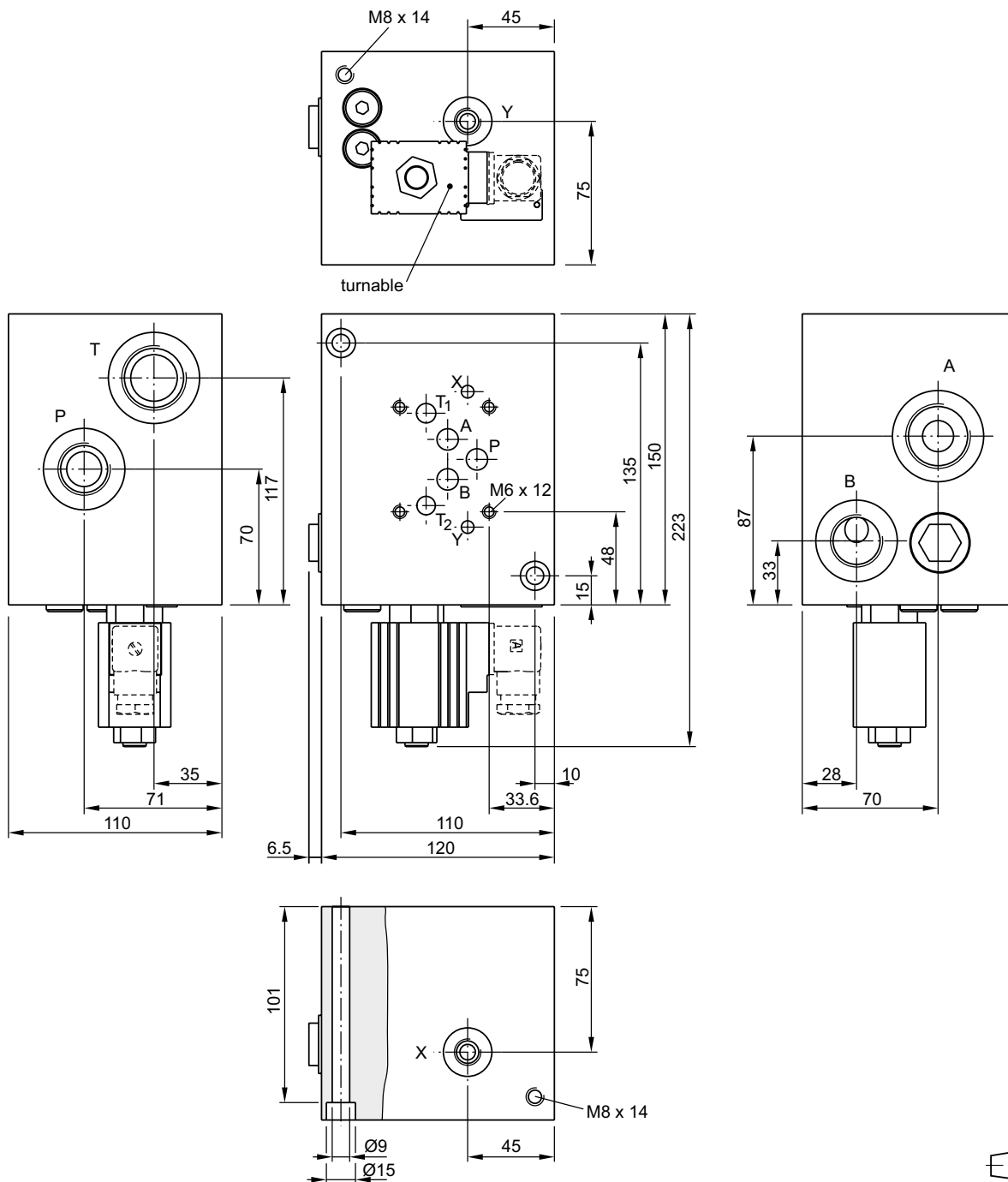

Symbol	Ordering code	Port	Kit
	<b>A10-1665L</b> CETOP 05	A, T = G1 B, P = G¾ X, Y = G¼	NBR: SK-A10-1665