

Parker Series H10 Sandwich Plates for Regenerative and Hybrid Circuits Service Manual

Sandwich plate H10-1662, mounting interface acc. DIN 24340-A10, CETOP 05 / NG10 for A-regeneration

p/Q performance curves

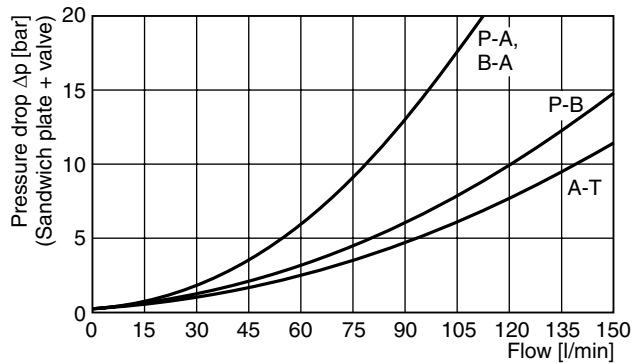



Measured with valves D31FP/FB/FC*, spool Z31 at command signal 100 %.

Curves for D3W, D31NW, D3FB and D3FP on request.

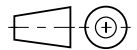
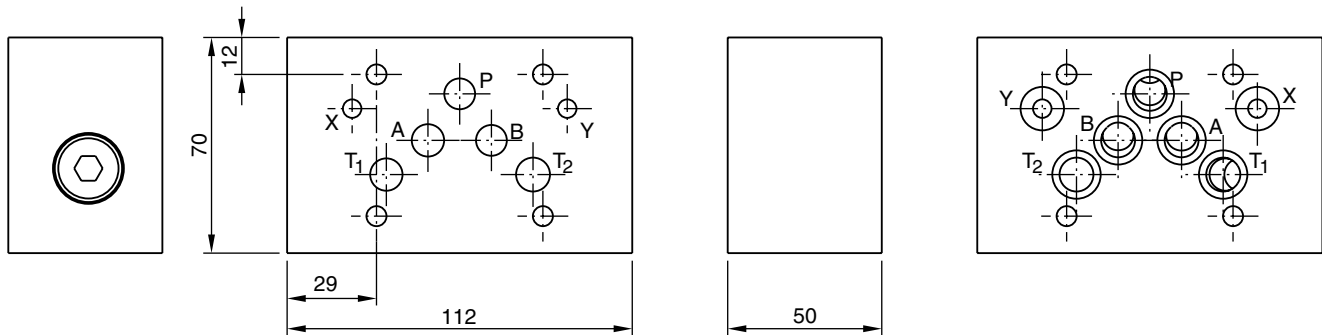
Dimensions

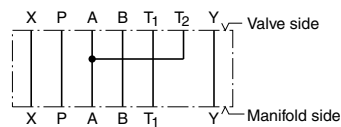

12

Symbol	Ordering code	 Kit	 Torque	 Kit
 <p>Valve side Manifold side</p>	<p>H10-1662 CETOP 05 (O-rings included in delivery)</p>	BK412	<p>4x M6x90 ISO 4762-12.9</p> <p>13.2 Nm \pm15 %</p>	NBR: SK-H10-1662

H10 UK.INDD CM 17.04.15

Sandwich plate H10-1666L, mounting interface acc. DIN 24340-A10, CETOP 05 / NG10 for hybrid function

p/Q performance curves

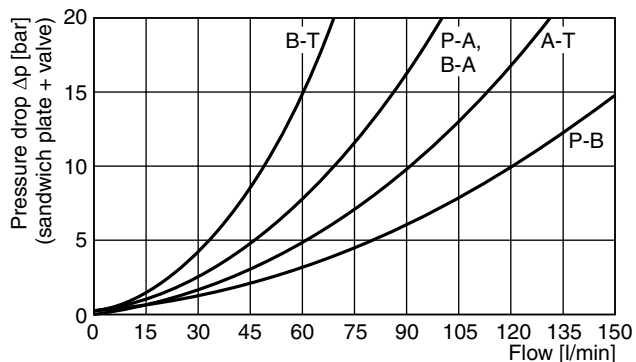

Measured with valves D31FP/FE/FB/FC*, spool Z31 at command signal 100 %.

Curves for D3W, D31NW, D3FB and D3FP on request.

Dimensions

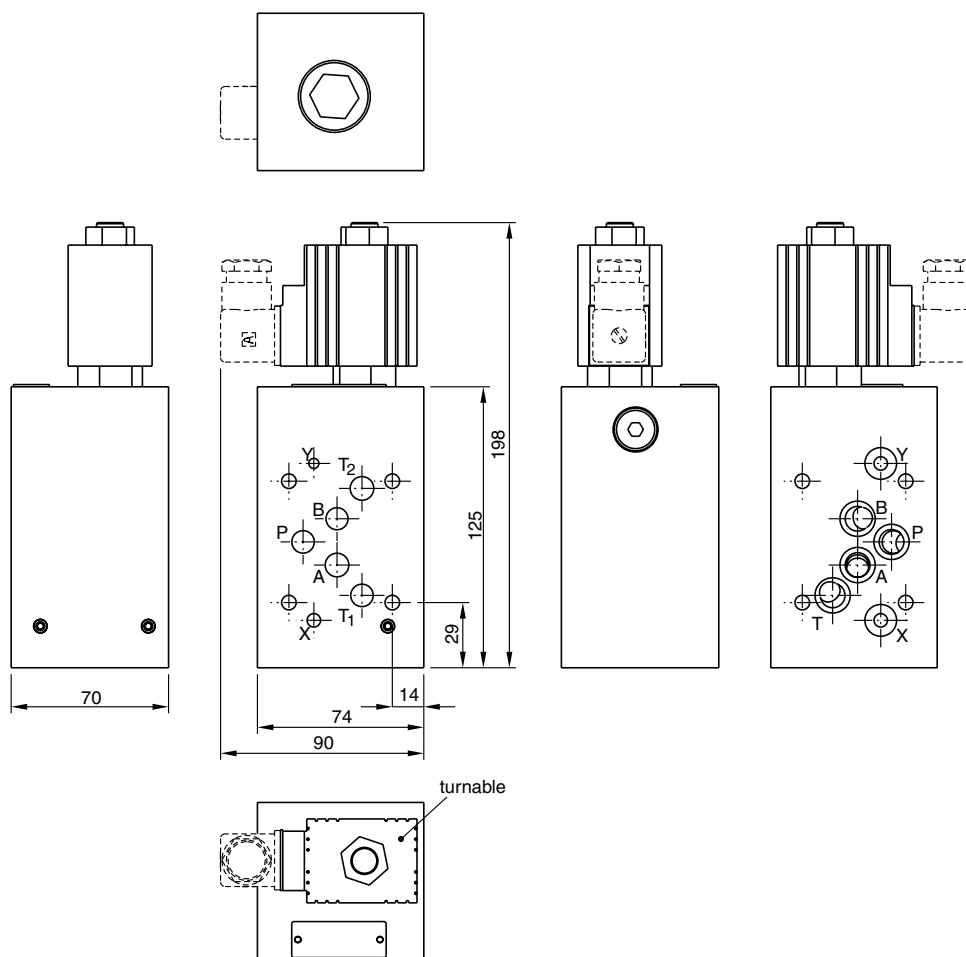

Symbol	Ordering code	Kit	Torque	Kit
<p>X P A B T₁ T₂ Y_v Valve side X P A B T Y_m Manifold side</p>	H10-1666L CETOP 05 (O-rings included in delivery)	BK528	4x M6x110 ISO 4762-12.9 13.2 Nm ±15 %	NBR: SK-H10-1666